

# Backlit Cube 0202 - Freestanding

CUBE-2X2-BL

Enhance brand visibility in a fun and unique way with the Formulate® Backlit Cube. Made out of tube structures and encased in pillowcase fabrics, it's lightweight and easy to setup and transport for multiple events. The LED lighting gives your visual messaging the pop it needs to stand out. Choose a standalone cube or stack several together for an eye-catching display.



We are continually improving and modifying our product range and reserve the right to vary the specifications without prior notice. All dimensions and weights quoted are approximate and we accept no responsibility for variance. E&OE. See Graphic Templates for graphic bleed specifications

## features and benefits:

- Stackable Formulate® Fabric Illuminated Cube
- LED lighting is suspended in the middle of the cube
- Zipper pillowcase fabric fits over lightweight tube structure
- Closed on all sides, with opening on bottom for power cord
- Easy set up and display; convenient to bring to multiple events
- Modular plug-in cord allows up to 10 backlit cubes to be daisy chained together. Additional cable(s) required.

## dimensions:

Hardware	Shipping
<p>Assembled Unit:</p> <p>24" w x 24" h x 24" d 609.6mm(w) x 609.6mm(h) x 609.6mm(d)</p> <p>Approximate Weight: 8 lbs / 3.6 kg</p>	<p><b>Packaging - 1 Box:</b> Shipping dimensions: 1x BOX: 24" L x 14" H x 8" D (609.6mm x 355.6mm x 203.2mm)</p> <p>Approximate shipping weight: 10 lbs / 4.5 kg</p>
Graphics	additional information:
<p>Graphic material: Backlit Textile (dye-sublimated fabric)</p> <p>See graphic templates for graphic sizes.</p> <p>Refer to related graphic templates for more information Visit:</p> <p><a href="https://www.theexhibitorshandbook.com/downloads/download-graphic-templates">https://www.theexhibitorshandbook.com/downloads/download-graphic-templates</a> or click here</p>	<ul style="list-style-type: none"><li>- Lifetime HW Warranty</li><li>- 1 Year Graphics Warranty</li><li>- Made in North America</li><li>- Recyclable</li></ul>

PART NUMBER	DESCRIPTION	QTY.
TC-30-3W	3 WAY CORNER CONNECTOR FOR 30MM TUBE	8
SPDR-30-S4-2	30MM STRAIGHT SPREADER S4-2 FOR CORNERS TO TC-30-90T JUNCTIONS OF 2 STRUCTURES USING SNAP BUTTONS, APPROX. 1.79FT	10
SPDR-30-S4-2 2x2-BL	30MM STRAIGHT SPREADER S4-2 FOR CORNERS TO TC-30-90T JUNCTIONS OF 2 STRUCTURES USING SNAP BUTTONS, APPROX. 1.79FT	2
CUBE-2X2-CABLE	CABLE, 1/16-48"	1
GRIPPER-LOOPER-2.5	GRIPPER-LOOPER, 2.5MM HOLES	2
LED-LT-FXT-NOPLUG	Light Bulb E26 Socket 10ft Extension Hanging Cord Lantern Cable UL Listed	1
LED-CORN-24W	LED CORN BULB 24W, COOL WHITE 6500K	1
VFF-LB-ACCORD-01	VECTOR FAST FRAME AC CORD	1

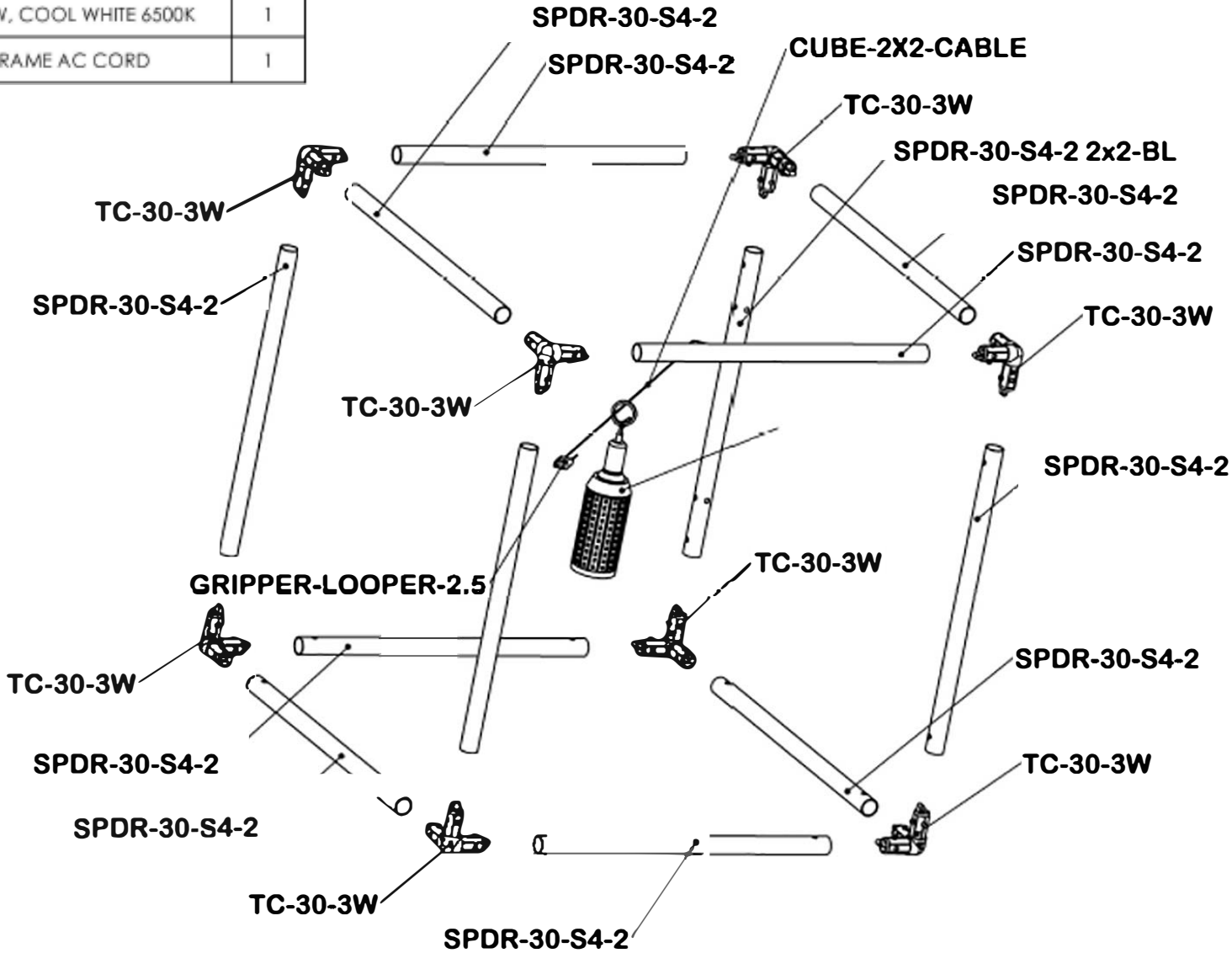

## Installing Cable

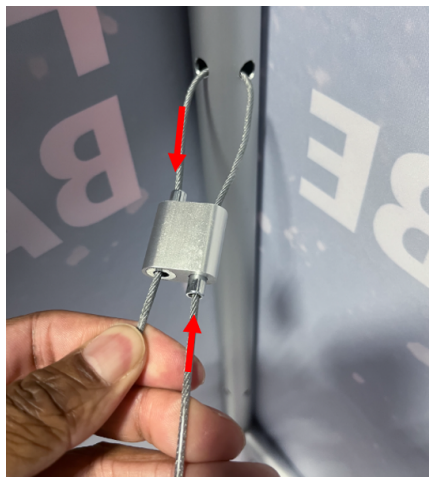
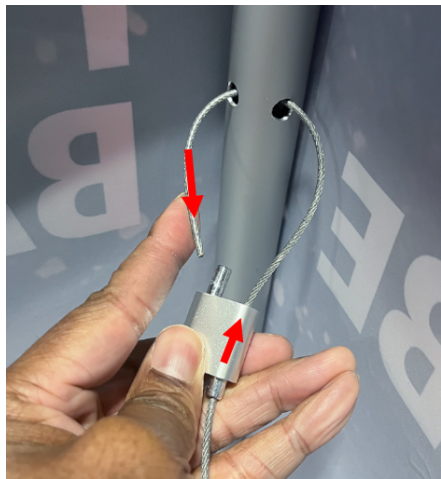

## Releasing Cable

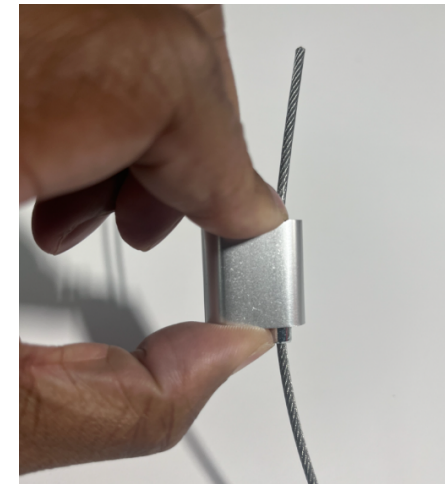

## Connecting Light



## Connecting Multiple Cubes

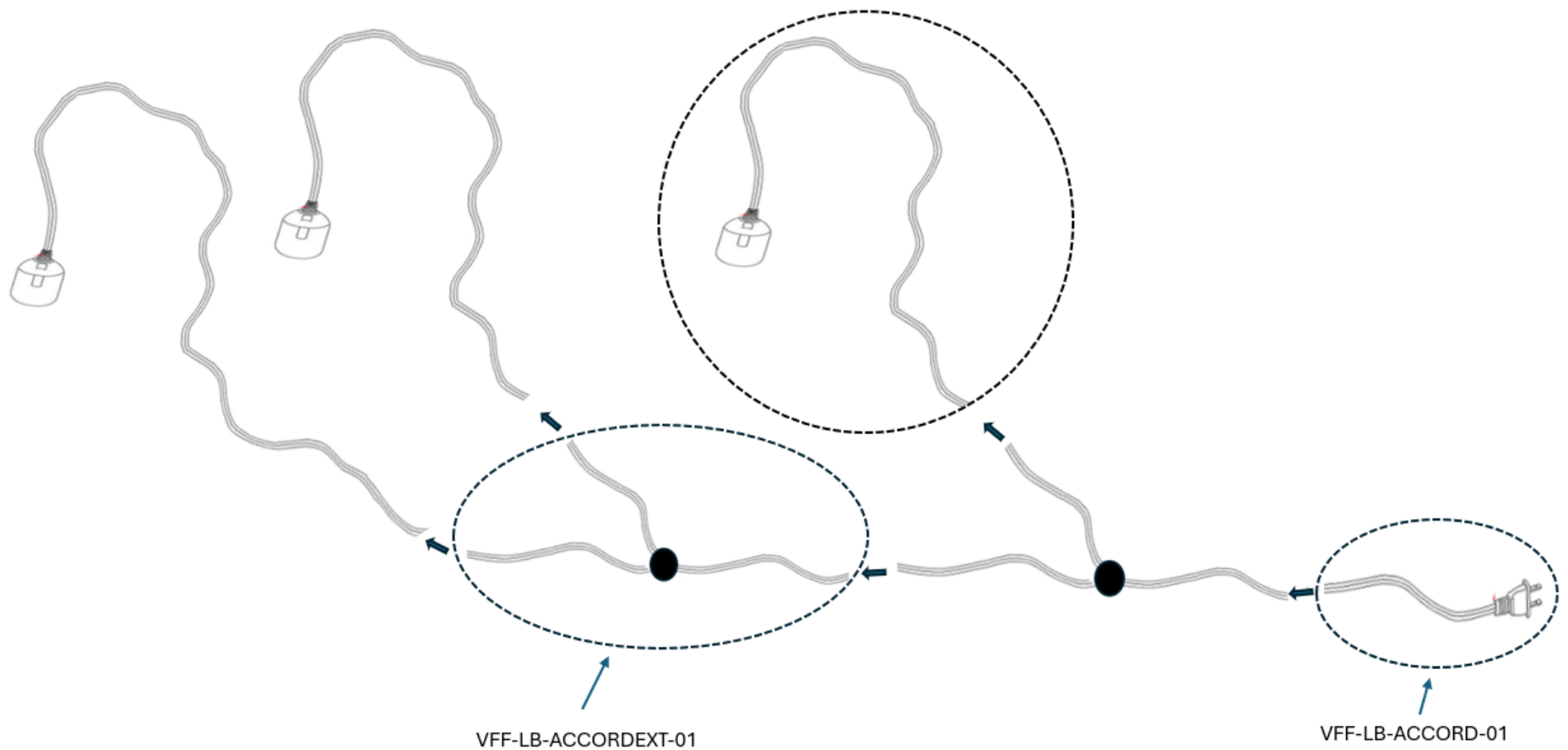

Qty. of VFF-LB-ACCORDEXT-01 needed = Qty. of cubes minus one